

ITEM 6.1: Major Project Permit Stage 2 – 1101 Galleria Boulevard – NCRSP PCL 35 – Fleming’s Prime Steakhouse – PL23-0252

REQUEST

The project applicant requests a Major Project Permit Stage 2 for site development and architectural review for a new 8,110 square-foot Fleming’s Prime Steakhouse restaurant. The application also includes a tree permit to remove one native oak tree from the existing landscape area.

Applicant – Terry Womack, Go2Permitting, LLC
Owner - Galleria Boulevard LLC

SUMMARY RECOMMENDATION

The Planning Division recommends that the Planning Commission take the following actions:

1. Adopt the two (2) findings of fact and approve the Major Project Permit Stage 2 subject to seventy-three (73) conditions of approval; and
2. Adopt the two (2) findings of fact and approve the Tree Permit subject to twenty (20) conditions of approval.

SUMMARY OF OUTSTANDING ISSUES

There are no outstanding issues associated with this request. The applicant has reviewed and is in agreement with the recommended conditions of approval.

BACKGROUND

The project site is a part of the Roseville Galleria Mall property, which is identified as North Central Roseville Specific Plan (NCRSP) Parcel 35. The subject property is also within the Roseville Galleria Mall master plan area. The site has a Regional Commercial land use designation and is also zoned Regional Commercial (RC/SA-NC).

On July 25, 1995, the Planning Commission approved a Major Project Permit Stage 1 (MPP 95-01) for development of a regional mall on Parcel 35 (regional mall MPP). On October 19, 2000, the Design Committee approved a Design Review Permit Modification (DRP-MOD) for construction of a Pier 1 Imports on the subject property. The Pier 1 building will be demolished for the construction of the new restaurant.

Figure 1: Project Site Location



The proposed project includes a new 8,110 square-foot Fleming’s Prime Steakhouse restaurant with related site improvements, including landscaping and a minor parking lot reconfiguration. Although the Pier 1 project was evaluated through the design review process, the proposed Fleming’s Prime Steakhouse is located on a property that was included in the MPP Stage 1 site plan. Therefore, the architecture of the Fleming’s Prime Steakhouse is being evaluated through the MPP Stage 2 process and not the design review process. It should be noted that the MPP Stage 2 and DRP processes are very similar in nature, one of the major differences being the approval body. A MPP is approved by the Planning Commission and a DRP is approved by the Design Committee.

SITE INFORMATION

Location: 1101 Galleria Boulevard

Total Size: 1.77 acres

Topography and Setting: The project is located on a developed parcel in a fully developed portion of the NCRSP. The site is adjacent to the western side of Galleria Boulevard and the southern side of an eastern entrance to the Galleria Mall. The site is surrounded by commercial and retail uses within the adjacent Galleria Mall and Creekside Retail Center.

MPP STAGE 2 EVALUATION

Section 19.82.030 of the City of Roseville Zoning Ordinance describes the procedures for a Major Project Permit (MPP). The intent of the MPP process is to streamline the review of large development projects that could be constructed over a period of several years. In accordance with the City’s MPP Ordinance, the MPP review process is segregated into three separate stages. Provided below is a summary of each stage:

- Stage 1: of the MPP application consists of the approval of a preliminary development plan. The preliminary development plan will establish the configuration of the buildings, conceptual building elevations, parking areas and ratios, landscaping and open space locations, rough grading and drainage on and off site, vehicular and pedestrian circulation, and development phasing. The complete environmental review of the project is also performed at this stage. The Planning Commission is the hearing authority for Stage 1 review and approval.
- Stage 2: of the MPP application process consists of the review of the detailed architecture and landscaping for the project. The Planning Commission is the hearing authority for Stage 2 review and approval.
- Stage 3: Stage 3 is an administrative review, approved by the Planning Manager, of the improvement plans and building plans for compliance with the conditions of the Stage 1 and 2 approvals.

The Galleria Mall development was approved through the MPP Stage 1 process. The subject parcel is shown as an out parcel on the regional mall MPP Stage 1 Site plan in its current configuration. Minimal modification to the parcel will occur with this project, and the proposed project is consistent with the site plan and assumed development within the regional mall MPP and no changes to the MPP Stage 1 approval are being requested.

Development of the proposed project is evaluated through the MPP Stage 2 process to review the building architecture for consistency with the intent of the MPP Stage 1 and the City’s Design Guidelines. The following sections include a MPP Stage 2 evaluation of the proposed architecture against the NCRSP Design Guidelines and the City’s Community Design Guidelines (CDGs). The required findings are listed below in ***italicized, bold text*** and are followed by an evaluation.

The findings for a Major Project Permit Stage 2 are as follows:

- 1. The Architecture and Landscaping is consistent with the General Plan, applicable Specific Plan, and adopted City design guidelines; and Phase 1 approval; and**
- 2. The design and installation of the Preliminary Development Plan shall not be detrimental to the public health and safety, or be materially detrimental to the public welfare.**

Site Design and Circulation

The project includes the construction of a new 8,110 square-foot restaurant with associated parking lot reconfiguration. The proposed site plan is shown in Figure 2. The entrance to the building will face south with the entrance to the parking lot located in the northwest corner of the site. The parking lot maintains two-way circulation throughout the site, with the sole point of ingress/egress provided via a driveway which leads to Galleria Boulevard. The applicant is proposing a slight reconfiguration of parking spaces on site, including the introduction of additional spaces along the northwestern drive aisle, creating an additional island in the center of the parking lot while shifting the existing island to the south, marking new ADA paths of travel, and the relocation of the existing trash enclosure from the northwest drive aisle adjacent to the building to the southwest corner of the parking lot.

Parking is typically reviewed during the Stage 1 approval process, but the minor parking lot reconfiguration allows for an opportunity to update the parking calculations for the site. The Zoning Ordinance outlines the parking requirements based on use type and an associated ratio per the square footage of each use type. Based on the square footage of the proposed building and the ratio outlined in the Zoning Ordinance of one space per 100 square feet, 81 parking spaces will be required. The site plan provides 82 parking spaces, which exceeds the City standard.

The refuse enclosure proposed at the southwestern corner of the site incorporates three bays to accommodate organic waste. The size and location of the enclosure was reviewed by the City’s Waste Management division to ensure adequate space for refuse truck turning movements.

Architecture

The Fleming’s Prime Steakhouse architectural design incorporates modern design elements, including horizontal rooflines, asymmetrical rectangular forms, and building materials and colors such as metal fascia and trellises, EIFS, and concrete masonry blocks (Figure 3 and Figure 4). All four elevations showcase a mixture of varying façade heights, depths, and colors including bronze, three different shades of gray, and black trim, coping, and trellises. The west, south, and east elevations all feature

Figure 2: Proposed Site Plan

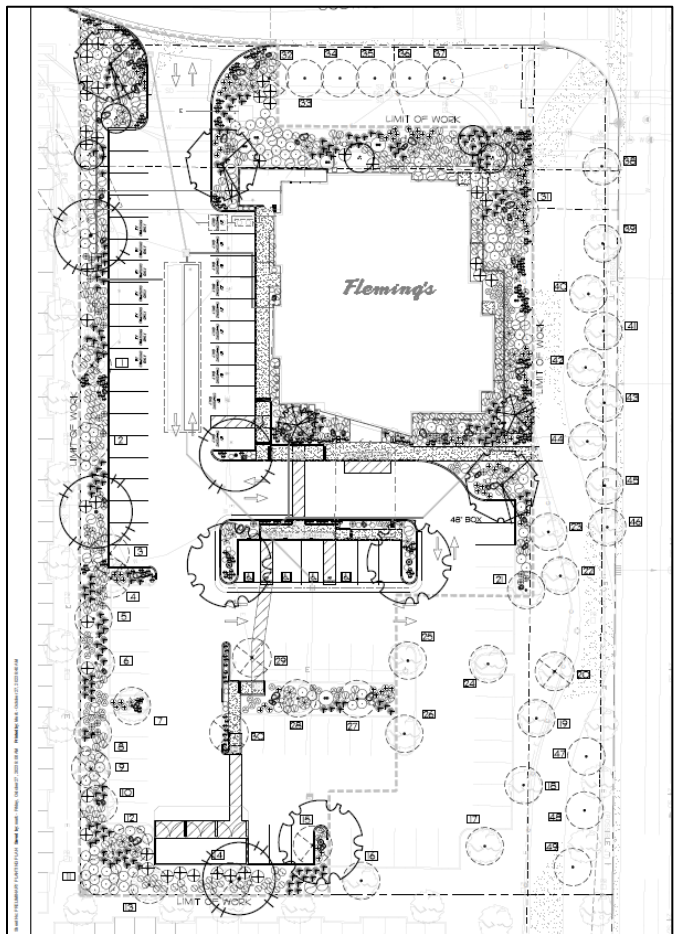

large window panels at varying heights and depths, providing additional visual interest. The architectural treatments will be applied to all sides of the building.

Figure 3: East and South Building Elevations



Figure 4: West and North Elevations



The proposed architectural design is consistent with both the NCRSP Design Guidelines and CDGs in the following ways:

- The architecture consists of a variety of colors and materials and variation in wall planes, rooflines, and building form that are consistent with the overall architectural style and theme of the project; and
- The design is original and distinct from the surrounding project while remaining complementary with the commercial character of the area.

Landscaping

The project includes extensive landscaping including the replacement of existing trees, one of which is considered protected under the City’s Tree Preservation Ordinance. The requirements of the tree removal and replacement are detailed below in the Tree Permit Evaluation. The existing landscaping along Galleria Boulevard will be maintained and enhanced and new trees will be planted within the parking area to provide shade as required by City ordinance. The landscape will enhance the building architecture while softening views of the building from the street and pedestrian walkways.

MPP Stage 2 Summary: Section 19.82.03.C.2 of the City of Roseville Zoning Ordinance requires that two findings be made to approve a MPP Stage 2. The two findings for approval are contained in the Recommendation section of this report. In summary, staff finds that the architecture and landscape plans for the proposed Fleming’s Prime Steakhouse are consistent with the NCRSP Design Guidelines and CDGs and will not be detrimental to the public health and safety or welfare, as described in detail above. As proposed and conditioned, the project complies with the required findings for approval. For these reasons, staff recommends approval of the MPP Stage 2 request.

TREE PERMIT EVALUATION

Pursuant to Zoning Ordinance Section 19.66.030, a Tree Permit is required for any removal of native oak trees or for more than 20% encroachment into the dripline of a native oak tree. The findings for a Tree Permit are as follows:

- 1. Approval of the Tree Permit will not be detrimental to the public health, safety or welfare, and approval of the Tree Permit is consistent with the provisions of Chapter 19.66.***
- 2. Measures have been incorporated into the project or permit to mitigate impacts to remaining trees or to provide replacement for trees removed.***

The Arborist Report prepared by Arbor Resources on July 15, 2023 documents the presence of 49 trees on the subject site. Many of these trees are not subject to the City’s Tree Preservation Ordinance, as they are not native oak trees or are undersized (less than six inches dbh). For reference, a list of trees authorized for removal or encroachment through the requested tree permit is included in the Arborist Report (Exhibit B) of this staff report and in Table 1 below. The project will remove a total of 6 trees, including 1 protected oak tree which totals 10 inches (dbh) in size.

Table 1: Tree Survey Summary – Protected Oak Trees

Tree #s	Disposition	# of Trees	# inches DBH
#3	To be removed	1	10
#7, 12, 17, 24	To be retained (no impact)	4	31

A review of the project plans shows that the removal of one listed tree is necessary in order to undertake the project. Tree #3 will need to be removed to realign the parking field and create an efficient site and parking layout. Tree #3 is listed as having fair health, but poor structure. Staff has determined that approval of the Tree Permit will not be detrimental to public health, safety, or welfare.

The Tree Preservation Ordinance includes multiple options for mitigation, with priority given to on-site planting. Where planting is not an option, the Tree Preservation Ordinance allows the payment of in-lieu fees; the applicant has agreed to mitigate via both methods. Conditions of approval have been added to this staff report which authorizes the removal of Tree #3, requires mitigation for the removal of Tree #3 through a combination of replanting and the payment of in-lieu fees, and requires the preservation of all other protected oak trees. Measures have been incorporated into the Tree Permit to mitigate impacts.

PUBLIC OUTREACH

The proposed project was distributed to the various agencies and departments which have requested notice of City applications, and all comments were considered and incorporated into the Conditions of Approval, as appropriate. Notice of the application was also distributed to the Roseville Coalition of Neighborhood Associations. No comments were received. A public notice of the Planning Commission hearing was published on November 30, 2023, and was distributed to all property owners within 300 feet of the project site. To date, no comments have been received.

CONCLUSION

As described in the analyses above, the requested Stage 2 building design is consistent with the Stage 1 approval, the NCRSP, the City’s Design Guidelines, and the City’s General Plan. Furthermore, the project will not be detrimental to the public.

ENVIRONMENTAL DETERMINATION

The project is categorically exempt from the provisions of the California Environmental Quality Act (CEQA) pursuant to CEQA Guidelines Section 15332, Class 32, which exempts In-Fill Development Projects that meet the following criteria:

- (a) The project is consistent with the applicable general plan designation and all applicable general plan policies as well as with applicable zoning designation and regulations.
- (b) The proposed development occurs within city limits on a project site of no more than five acres substantially surrounded by urban uses.
- (c) The project site has no value, as habitat for endangered, rare or threatened species.
- (d) Approval of the project would not result in any significant effects relating to noise, air quality, or water quality.
- (e) The site can be adequately served by all required utilities and public services.

The project meets these criteria for the following reasons and is therefore exempt:

- (a) The general plan designation of Regional Commercial allows for Restaurant uses.
- (b) The total project site encompasses 1.77 acres.
- (c) The project site has been previously developed and does not contain habitat for endangered, rare or threatened species.
- (d) The proposed use will not have significant effects on traffic, noise, air quality, or water quality.
- (e) The site can be adequately served by required utilities and public services allocated to the site.

RECOMMENDATION

The Planning Division recommends the Planning Commission take the following actions:

1. Adopt the findings of fact as stated in the staff report and approve the MAJOR PROJECT PERMIT STAGE 2 – 1101 GALLERIA BLVD – NCRSP PCL 35 – FLEMING’S PRIME STEAKHOUSE PL23-0252 subject to seventy-three (73) conditions of approval; and
2. Adopt the findings of fact as stated in the staff report and approve the TREE PERMIT – 1101 GALLERIA BLVD – NCRSP PCL 35 – FLEMING’S PRIME STEAKHOUSE PL23-0252 subject to twenty (20) conditions of approval.

CONDITIONS OF APPROVAL FOR A MAJOR PROJECT PERMIT STAGE 2

1. This Major Project Permit Phase 2 approval shall be effectuated within a period of two (2) years from **January 11, 2024** and if not effectuated shall expire on **January 11, 2026**. Prior to said expiration date, the applicant may apply for an extension of time, provided this approval does not extend the expiration beyond **January 11, 2026**. (Planning)
2. The project is approved as shown in Exhibits A and B and as conditioned or modified below. (Planning)
3. The project shall be addressed as 1101 Galleria Blvd. All projects with multi-tenants or buildings must submit a site plan with building footprint(s) to the Development Services Department (Business Services – Addressing) for building/suite addressing. (Business Services)
4. The applicant shall pay City’s actual costs for providing plan check, mapping, GIS, and inspection services. This may be a combination of staff costs and direct billing for contract professional services. Project billing may occur up to two (2) months after the end of warranty or the Notice of Termination date for the SWPPP, whichever occurs later. (Engineering, Environmental Utilities, Electric, Finance)
5. The design and construction of all improvements shall conform to the Design and Construction Standards of the City of Roseville, or as modified by these conditions of approval, or as directed by the City Engineer. (Engineering)
6. The applicant shall not commence with any on-site improvements or improvements within the right-of-way until such time as grading and/or improvement plans have been submitted for review and are approved with grading and/or encroachment permits issued by the Department of Development Services – Engineering Division. (Engineering)
7. The approval of this project does not constitute approval of proposed improvements as to size, design, materials, or location, unless specifically addressed in these conditions of approval. The Developer shall submit civil drawings to the Department of Development Services – Engineering Division for review and approval. (Engineering)

PRIOR TO ISSUANCE OF BUILDING PERMITS:

8. Parking lot design shall conform to the City's design standards, including the following minimum standards for parking stalls:
 - a. All parking stalls shall be double-striped. Parking stalls adjacent to sidewalks, landscaped areas or light fixtures, and all Accessible stalls shall abut a 6-inch raised curb or concrete bumper. (Planning)
 - b. Standard – 9 feet x 18 feet; Compact – 9 feet x 16 feet; Accessible – 14 feet x 18 feet (a 9-foot-wide parking area plus a 5-foot-wide loading area) and a minimum of one (1) parking space shall be Accessible van accessible – 17 feet x 18 feet (9-foot-wide parking area plus an 8-foot-wide loading area). (Planning)
 - c. An 'exterior routes of travel' site accessibility plan incorporating slope, cross-slope, width, pedestrian ramps, curb ramps, handrails, signage, detectable warnings or speed limit signs or equivalent means shall comprise part of the site improvement plans submitted to City for review, prior to building plan check approvals. This site accessibility plan shall also include:
 - i. Accessible parking stalls shall be dispersed and located closest to accessible entrances. The total number of accessible parking spaces shall be established by Table 11B-208.2 of the CBC.
 - ii. Accessible Parking spaces and crosswalks shall be signed, marked and maintained as required by Chapter 11 of the CBC.
 - iii. Accessible parking and exterior route of travel shall comply with CBC, Sections 11B-206 and 11B-208. (Building)
9. Signs and/or striping shall be provided on-site as required by the Planning Department to control on-site traffic movements. Parking lot striping and signage shall be maintained in a visible and legible manner. (Planning)
10. The plans submitted to the Building Division for permits shall indicate all approved revisions/alterations as approved by the Commission including all conditions of approval. (Planning)
11. The project Landscape Plans shall comply with the following:
 - a. The Landscape Plan shall indicate the location of, and be designed to avoid conflicts with, all pole-mounted light fixtures and utility equipment including (but not limited to) electric transformers, switchgear, and overhead lines; backflow preventers; fire department connections; and public water, sewer, and storm drain facilities. (Planning, Fire, Environmental Utilities, Electric, Public Works)
 - b. The tree plantings in the parking lot shall be designed to provide a minimum of 50% shade coverage after 15 years. (Planning)
 - c. At a minimum, landscaped areas not covered with live material shall be covered with a rock, (3") bark (no shredded bark) or (3") mulch covering. (Planning)
 - d. The landscape plan shall comply with the Landscape Guidelines for the North Central Roseville Specific Plan and the City of Roseville Water Efficient Landscape Ordinance. (Planning, Environmental Utilities)

- e. Landscaping adjacent to preserve areas shall consist of California native, drought-tolerant groundcover, shrubs, plants, and trees. (Open Space, Planning)
 - f. All landscaping in areas containing electrical service equipment shall conform to the Electric Department's Landscape Requirements and Work Clearances as outlined in Section 10.00 of the Departments "Specification for Commercial Construction." (Electric)
 - g. Slopes within landscape planters shall be no more than 3:1. A two-foot flat bench located at back-of-walk shall be included in the landscape area to slow or allow absorption of nuisance run-off from the planters. (Parks, Recreation, and Libraries)
 - h. All landscaping shall conform to the standards of crime prevention through environmental design with the intent to create natural surveillance, controlling access, and territorial reinforcement to property boundaries. (Police)
12. Any roof-mounted equipment and satellite dishes proposed shall be shown on the building plans. The equipment shall be fully screened from public streets and the surrounding properties. (Planning)
13. At the time of building permit application and plan submittal, the project applicant shall submit a proposed plan which shows the proposed addressing for the building. The Building Official, or the designee, shall approve said plan prior to building permit approval. Refer to the *City of Roseville Addressing Guidelines*. (Building)
14. A separate Architectural Site Accessibility Plan which details the project's site accessibility information as required by California Title 24, Part 2 shall be submitted as part of the project Building Permit Plans. (Building)
15. For Multiple Building Complexes: As part of the required Architectural Site Accessibility Plan, the developer shall delineate the extent of the site accessibility improvements being installed as part of the initial improvements for the project, and those that are planned to be developed as part of subsequent phases (i.e. around future pad buildings). (Building)
16. Building permit plans shall comply with all applicable code requirements (California Building Code – CBC – based on the International Building Code, California Green Building Standards Code– CGBSC, California Mechanical Code – CMC – based on the Uniform Mechanical Code, California Plumbing Code – CPC – based on the Uniform Plumbing Code, California Fire Code – CFC – based on the International Fire Code – with City of Roseville Amendments – RFC, California Electrical Code – CEC – based on the National Electrical Code, and California Energy Standards – CEC T-24 Part 6), California Title 24 and the American with Disabilities Act - ADA requirements, and all State and Federally mandated requirements in effect at the time of submittal for building permits (contact the Building Division for applicable Code editions). (Building)
17. For restaurants, other food services, or commercial swimming pools: The developer shall obtain all required approvals and permits from the Placer County Health Department and the City of Roseville Industrial Waste Division. (Building, Environmental Utilities)
18. Maintenance of copy of building plans: Health and Safety Code section 19850 requires the building department of every city or county to maintain an official copy of the building plans for the life of the building. As such, each individual building shall be submitted as a separate submittal package. Building plan review, permit issuance and archiving is based on each individual building address. (Building)

19. For all work to be performed off-site, permission to enter and construct shall be obtained from the property owner, in the form of a notarized right-of-entry. Said notarized right-of-entry shall be provided to Development Services - Engineering prior to approval of any plans. (Engineering)
20. The Improvement Plans shall include a complete set of Landscape Plans. The Landscape Plans shall be approved with the Improvement Plans. (Planning, Engineering, Fire, Environmental Utilities, Electric)
21. A note shall be added to the grading plans that states:

*“Prior to the commencement of grading operations, the contractor shall identify the site where the **excess/borrow** earthen material shall be imported/deposited. If the **borrow/deposit** site is within the City of Roseville, the contractor shall produce a report issued by a geotechnical engineer to verify that the exported materials are suitable for the intended fill, and shall show proof of all approved grading plans. Haul routes to be used shall be specified.”* (Engineering)
22. The applicant shall dedicate all necessary rights-of-way or Public Utility Easement for the widening of any streets or transfer of public utilities across and over any portion of the property as required with this entitlement. A separate document shall be drafted for approval and acceptance by the City of Roseville, and recorded at the County Recorder's Office. (Engineering)
23. Bike parking and electric vehicle parking spaces shall be provided per the California Green Building Standards. Carpool spaces shall also be provided per the City of Roseville's Transportation System Management (TSM) Ordinance, R.M.C Chapter 11.33. Bike rack/locker design and designated parking space markings and location shall be approved by Alternative Transportation. (Alternative Transportation, Building).
24. Remove and relocate the existing driveway. The proposed driveway shall match the geometrics of the existing driveway. (Engineering)
25. All storm drainage, including roof drains, shall be collected on site and treated with Best Management Practices (BMP's) per the City's Stormwater Quality Design Manual, which includes trash capture requirements. All storm water shall be routed to the nearest existing storm drain system or natural drainage facility. Drain outfalls shall extend down to the receiving water and shall be constructed with adequate velocity attenuation devices. The grading/improvement plans for the site shall be accompanied with a shed map that defines that area tributary to this site and all drainage facilities shall be designed to accommodate the tributary flow. The storm drain system and proposed BMP's shall be privately owned and maintained by the property owner. Prior to the issuance of any permits, the owner shall provide a plan for the maintenance of the proposed BMP's. (Engineering)
26. Prior to the approval of the Improvement Plans, the project proponent shall provide proof of preparation and submittal of a Storm Water Pollution Prevention Plan (SWPPP) to the Regional Water Quality Control Board (RWQCB). Proof shall be in the form of the Waste Discharge Identification Number (WDID#), provided to the applicant from RWQCB, placed on the coversheet of the improvement plans. Upon approval of the improvement plans, a copy of the SWPPP shall be required onsite and available for viewing by City inspection staff upon request. (Engineering)
27. The developer shall be responsible for any necessary relocation of signal interconnect cables that may require re-location as a result of the construction of turn lanes and/or driveways. (Engineering)
28. To ensure that the design for any necessary widening, construction, or modifications of Public Streets does not conflict with existing dry utilities generally located behind the curb and gutter, and prior to the submittal of design drawings for those frontage improvements, the project proponent shall have the existing dry utilities pot holed for verification of location and depth. (Engineering)

29. Sight distances for all driveways shall be clearly shown on the improvement plans to verify that minimum standards are achieved. It will be the responsibility of the project proponent to provide appropriate landscaping and improvement plans, and to relocate and/or modify existing facilities as needed to meet these design objectives. (Engineering)
30. The applicant shall remove and reconstruct any existing damaged curb, gutter, and sidewalk along the property frontage. During plan check of the improvement plans and/or during inspection, Development Services - Engineering will designate the exact areas to be reconstructed. Any existing public facilities damaged during the course of construction shall be repaired by the property owner and at the property owner's expense, to the satisfaction of the City. (Engineering)
31. Prior to the approval of the improvement plans, it will be the project proponent's responsibility to pay the standard City Trench Cut Recovery Fee for any cuts within the City streets that are required for the installation of underground utilities. (Engineering)
32. Prior to the issuance of building permits, the property owner shall pay into the following fee programs: Citywide Drainage Fee, Citywide Traffic Mitigation Fee (TMF), Highway 65 Joint Partners Association (JPA), South Placer Regional Transportation Authority (SPRTA), and City/County Fee. (Engineering)
33. Prior to the issuance of a grading permit or approval of Improvement Plans, the grading plans shall clearly identify all existing water, sewer and recycled water utilities within the boundaries of the project (including adjoining public right of way). Existing utilities shall be identified in plan-view and in profile-view where grading activities will modify existing site elevations over top of or within 15 feet of the utility. Any utilities that could potentially be impacted by the project shall be clearly identified along with the proposed protection measures. The developer shall be responsible for taking measures and incurring costs associated with protecting the existing water, sewer and recycled water utilities to the satisfaction of the Environmental Utilities Director. (Environmental Utilities)
34. The applicant shall pay all applicable water and sewer fees. (Environmental Utilities)
35. Water and sewer infrastructure shall be designed pursuant to the adopted City of Roseville Improvement Standards and the City of Roseville Construction Standards and shall include:
 - a. Utilities or permanent structures shall not be located within the area which would be disturbed by an open trench needed to expose sewer trunk mains deeper than 12 feet unless approved by Environmental Utilities in these conditions. The area needed to construct the trench is a sloped cone above the sewer main. The cone shall have 1:1 side slopes.
 - b. Water and sewer shall not exceed a depth of 12 feet below finished grade, unless authorized in these conditions of approval.
 - c. All sewer manholes shall have all-weather, 10-ton vehicle access unless otherwise authorized by these conditions of approval. (Environmental Utilities)
36. Trash enclosures, recycling areas, and enclosure approaches shall be designed to current Refuse Division specifications, the materials and colors shall match the building, and the location of such facilities shall be reviewed and approved by the Refuse Division, Planning and the Fire Department. The enclosure must have inside dimensions of 12 feet wide and 9 feet deep and be built to the specifications of the Solid Waste Department's Enclosure Description. (Refuse, Planning, Fire)
37. Access to trash enclosures shall have an inside turning radius of 25 feet and an outside turning radius of 45 feet must be maintained to allow the refuse truck access to and from the enclosure.

Enclosures must have a clear approach of 65 feet in front of the enclosure to allow servicing bins. (Refuse)

38. A trash enclosure, organics enclosure and recycling enclosure is required for each building and each tenant, otherwise, the building owner is responsible for the trash service. (Refuse)
39. The design and installation of all fire protection equipment shall conform to the California Fire Code and the amendments adopted by the City of Roseville, along with all standards and policies implemented by the Roseville Fire Department. (Fire)
40. The applicable codes and standards adopted by the City shall be enforced at the time construction plans have been submitted to the City for permitting. (Fire)
41. The Electric Department requires the submittal of the following information in order to complete the final electric design for the project:
 - a. one (1) set of improvement plans
 - b. load calculations
 - c. electrical panel one-line drawings
42. All on-site external lighting shall be installed and directed to have no off-site glare. Lighting within the parking areas and pedestrian walkways shall provide a maintained minimum of one (1) foot-candle, and 0.5 foot-candle of light, respectively. All exterior light fixtures shall be vandal resistant. (Planning, Police)
43. The parking lot shall have properly posted signs that state the use of the parking area is for the exclusive use of employees and customers of this project. (See California Vehicle Code Sections 22507.8, 22511.5, 22511.8, 22658(a), and the City of Roseville Municipal Code Section 11.20.110). The location of the signs shall be shown on the approved site plan. (Planning, Police)
44. It is the developer's responsibility to notify PG&E of any work required on PG&E facilities. (PG&E)

DURING CONSTRUCTION & PRIOR TO ISSUANCE OF OCCUPANCY PERMITS:

45. Any backflow preventers visible from the street shall be painted green to blend in with the surrounding landscaping. The backflow preventers shall be screened with landscaping and shall comply with the following criteria:
 - a. There shall be a minimum clearance of four feet (4'), on all sides, from the backflow preventer to the landscaping.
 - b. For maintenance purposes, the landscaping shall only be installed on three sides and the plant material shall not have thorns.
 - c. The control valves and the water meter shall be physically unobstructed.
 - d. The backflow preventer shall be covered with a green cover that will provide insulation. (Planning, Environmental Utilities)
46. The following easements shall be provided by separate instrument and shown on the site plan, unless otherwise provided for in these conditions:

- a. Additional internal easements will be required to cover primary electrical facilities to the project when the final electrical design is completed. (Electric)
47. Easement widths shall comply with the City's Improvement Standards and Construction Standards. Separate document easements required by the City shall be prepared in accordance with the City's "Policy for Dedication of Easements to the City of Roseville". All legal descriptions shall be prepared by a licensed land Surveyor. All existing public utility, electric, water, sewer and reclaimed water easements shall be maintained unless otherwise authorized by these conditions of approval. (Engineering, Environmental Utilities, Electric)
48. Inspection of the potable water supply system on new commercial/industrial/office projects shall be as follows:
 - a. The Environmental Utilities Inspector will inspect all potable water supply up to the downstream side of the backflow preventer.
 - b. The property owner/applicant shall be responsible for that portion of the water supply system from the backflow preventer to the building. The builder/contractor shall engage a qualified inspector to approve the installation of this portion of the water supply. The Building Division will require from the builder/contractor, a written document certifying that this portion of the potable water supply has been installed per improvement plans and in accordance with the Uniform Plumbing Code. This certificate of compliance shall be submitted to the Building Division before a temporary occupancy or a building final is approved.
 - c. The building inspectors will exclusively inspect all potable water supply systems for the building from the shutoff valve at the building and downstream within the building. (Building, Environmental Utilities)
49. All improvements being constructed in accordance with the approved grading and improvement plans shall be accepted as complete by the City. (Engineering)
50. The words "traffic control appurtenances" shall be included in the list of utilities allowed in public utilities easements (PUE's) located along public roadways. (Engineering)
51. Water, sewer and reclaimed water shall be constructed pursuant to the adopted City of Roseville Improvement Standards and the City of Roseville Construction Standards. (Environmental Utilities)
52. All water backflow devices shall be tested and approved by the Environmental Utilities Department. (Environmental Utilities)
53. **Restaurants or other Food Service Establishment (FSE).** The applicant shall design for installation and/or install an exterior grease interceptor if the proposed business could potentially discharge substances containing fats, oils and grease (FOG) into the sewer system. The grease interceptor shall be adequate to separate and remove FOG contained in the wastewater from FSE's prior to discharge to the public sewer. (Environmental Utilities)
54. In the event an exterior grease interceptor cannot be installed due to space limitation, the developer shall install a grease trap, per City Standards, that will mechanically separate the FOG contained in the wastewater from the FSE prior to discharge to the public sewer. (Environmental Utilities)
55. Pursuant to the Municipal Code, the applicant shall apply for and obtain a FOG waste discharge permit (FOG WDP) from the Environmental Utilities Industrial Waste Division prior to occupancy or prior to discharging waste to the public sewer. The applicant shall submit information required by the Environmental Utilities Department for evaluation, including but not limited to: site plans, floor

plans, mechanical and plumbing plans, and details to show all sewers, FOG control device, grease interceptor or other pretreatment equipment and appurtenances by size, location and elevation. Additional information related to the applicant's business operations and potential discharge may be requested to properly evaluate the FOG WDP application. (Environmental Utilities)

56. All Electric Department facilities, including streetlights where applicable, shall be designed and built to the "City of Roseville Specifications for Commercial Construction." (Electric)
57. The City of Roseville Electric Department has electrical construction charges which are to be paid by the developer and which are explained in the City of Roseville "Specification for Commercial Construction." These charges will be determined upon completion of the final electrical design. (Electric)
58. Any relocation, rearrangement, or change of existing electric facilities due to this development shall be at the developer's expense. (Electric)
59. Any facilities proposed for placement within public/electric utility easements shall be subject to review and approval by the Electric Department before any work commences in these areas. This includes, but is not limited to, landscaping, lighting, paving, signs, trees, walls, and structures of any type. (Electric)
60. All electric metering shall be directly outside accessible. This can be accomplished in any of the following ways:
 - a. Locate the metered service panel on the outside of the building.
 - b. Locate the metered service panel in a service room with a door that opens directly to the outside. The developer will be required to provide a key to the door for placement in a lock box to be installed on the outside of the door. Any doors leading from the service room to other areas of the building shall be secured to prohibit unauthorized entry. (Electric)
61. One ¾-inch conduit with a 2-pair phone line shall be installed from the building's telephone service panel to the meter section of the customer's electrical switchgear or panel. (Electric)
62. It is the responsibility of the developer to ensure that all existing electric facilities remain free and clear of any obstruction during construction and when the project is complete. (Electric)

OTHER CONDITIONS OF APPROVAL:

63. Signs shown on the elevations are not approved as part of the Design Review Permit. A Sign Permit is required for all project signs. (Planning)
64. Following the installation of the landscaping, all landscape material shall be maintained in a healthy and weed-free condition; dead plant material shall be replaced immediately. All trees shall be maintained and pruned in accordance with the accepted practices of the International Society of Arboriculture (ISA). (Planning)
65. The City reserves the right to restrict vehicle turning movements within the public right-of-way in the future if deemed necessary by the City Engineer. (Engineering)
66. The required width of fire apparatus access roads shall not be obstructed in any manner, including the parking of vehicles. Minimum required widths and vertical clearances established by the Fire Code shall be maintained at all times during construction. Closure of accesses for fire apparatus by gates, barricades and other devices shall be prohibited unless approved by the Fire Chief. (Fire)

67. Temporary aboveground storage tanks may be used at construction sites for diesel fuel only and shall not exceed 1,000 gallon capacity. Tanks shall comply with all provisions found within the Fire Code. A Fire Department Permit shall be obtained prior to tank installation. The permit shall expire after 90 days from the date of issuance, unless extended by the Fire Chief. (Fire)
68. If site survey or earth moving work results in the discovery of hazardous materials in containers or what appears to be hazardous wastes released into the ground, the contractor or person responsible for the building permit must notify the Roseville Fire Department immediately. A representative from the Fire Department will make a determination as to whether the incident is reportable or not and if site remediation is required. (Fire)
69. The location and design of the gas service shall be determined by PG&E. The design of the gas service for this project shall not begin until PG&E has received a full set of City approved improvement plans for the project. (PG&E)
70. The project is subject to the noise standards established in the City's Noise Ordinance. In accordance with the City's Noise Ordinance, project construction is exempt between the hours of seven a.m. and seven p.m. Monday through Friday, and between the hours of eight a.m. and eight p.m. Saturday and Sunday, provided that all construction equipment shall be fitted with factory installed muffling devices and be maintained in good working order. (Building)
71. The developer (or designated consultant) shall certify that the building foundation location has been placed according to all approved setback requirements shown on the approved site plan. The developer shall prepare a written statement confirming building placement and provide an original copy to the City Building Division Field Inspector at the time of or prior to the foundation inspection. (Building)
72. Prior to Certificate of Occupancy, the applicant may apply for a Temporary Certificate of Occupancy (TCO) of the building. If a TCO is desired, the applicant must submit a written request to the Building Division a minimum of thirty (30) days prior to the expected temporary occupancy date and shall include a schedule for occupancy and a description of the purpose for the Temporary Certificate of Occupancy. (Building)
73. Concurrent with submittal for plan check and prior to a request for final building inspection, the applicant may request City approval of an occupancy phasing plan to allow individual or multiple building occupancies. This request shall be made in writing to the Building Division and shall include the following:
 - a. A description of measures that will be undertaken to minimize conflict between residents/building occupants and construction traffic (e.g. fencing, etc.);
 - b. A phasing plan showing the proposed buildings, internal roads and access routes, landscaping, trash enclosure locations, and any other improvements planned for each phase; and
 - c. An estimated time frame for each phase and a specific date for the first phase. (Planning, Building)

CONDITIONS OF APPROVAL FOR TREE PERMIT FILE# PL23-0252

1. The project is approved as shown in Exhibit B and as conditioned or modified below. The Tree Permit approval shall run with the Major Project Permit. (Planning)

PRIOR TO ISSUANCE OF ANY PERMITS OR ANY CONSTRUCTION ON-SITE

2. All recommendations contained in the Arborist Report (Exhibit B) are incorporated by reference into these conditions, except as modified herein. (Planning)
3. Trees listed in Exhibit B, including Tree #3, are approved for removal with this tree permit. All other native oak trees shall remain in place. Trees to be removed shall be clearly marked in the field and inspected by Planning Staff prior to removal. Removal of the trees shall be performed by or under the supervision of a certified arborist. (Planning)
4. The developer shall be responsible for the replacement of the total number of inches proposed for removal prior to any tree removal. The total number of inches for this project is 10 inches DBH. Mitigation must be provided prior to tree removal unless otherwise approved in the tree replacement plan or in these conditions. (Planning)
5. No activity shall be permitted within the protected zone of any native oak tree beyond those identified by this report. (Planning)
6. A \$10,000 cash deposit or bond (or other means of security provided to the satisfaction of the Planning Division) shall be posted to ensure the preservation of all remaining trees during construction. The cash deposit or bond shall be posted in a form approved by the City Attorney. Each occurrence of a violation on any condition regarding tree preservation shall result in forfeiture of all or a portion of the cash deposit or bond. (Planning)
7. A violation of any of the conditions of this Tree Permit is a violation of the Roseville Municipal Code, the Zoning Ordinance (Chapter 19.74) and the Tree Preservation Ordinance (Chapter 19.66). Penalties for violation of any of the conditions of approval may include forfeiture of the bond, suspension or revocation of the permit, payment of restitution, and criminal penalties. (Planning)
8. A fencing plan shall be shown on the approved site plan and/or improvement plans demonstrating the Protected Zone for the affected trees. A maximum of three feet beyond the edge of the walls, driveways, or walkways will be allowed for construction activity and shall be shown on the fencing plan. The fencing plan shall be reviewed and approved by the Planning Division prior to the placement of the protective fencing. (Planning)
9. The applicant shall install a minimum of a five-foot high chain link fence (or acceptable alternative) at the outermost edge of the Protected Zone of the oak tree. Where encroachment is permitted pursuant to Condition 4, above, the fencing for encroachments shall be installed at the limit of construction activity. The applicant shall install signs at two equidistant locations on the temporary fence that are clearly visible from the front of the lot and where construction activity will occur. The size of each sign shall be a minimum of two feet (2') by two feet (2') and must contain the following language: "WARNING THIS FENCE SHALL NOT BE REMOVED OR RELOCATED WITHOUT WRITTEN AUTHORIZATION FROM THE PLANNING DIVISION". (Planning)
10. Once the fencing is installed, the applicant shall schedule an appointment with the Planning Division to inspect and approve the temporary fencing before beginning any construction. (Planning)
11. The applicant shall arrange with the arborist to perform, and certify in writing, the completion of deadwooding, fertilization, and all other work recommended for completion prior to the approval of improvement plans. Pruning shall be done by an Arborist or under the direct supervision of a Certified Arborist, in conformance with International Society of Arboriculture (I.S.A.) standards. Any watering and deep root fertilization which the arborist deems necessary to protect the health of the trees as

noted in the arborist report or as otherwise required by the arborist shall be completed by the applicant. (Planning)

12. A utility trenching pathway plan shall be submitted depicting all of the following systems: storm drains, sewers, water mains, and underground utilities. The trenching pathway plan shall show the proposed locations of all lateral lines. (Planning)
13. A Site Planning Meeting shall be held with the applicant, the applicant's primary contractor, the Planning Division and the Engineering Division to review this permit, the approved grading or improvement plans, and the tree fencing prior to any grading on-site. The Developer shall call the Planning Division and Engineering Division two weeks prior to the start of grading work to schedule the meeting and fencing inspection. (Planning)
14. The following information must be located on-site during construction activities: Arborist Report, approved site plan/improvement plans including fencing plan, and conditions of approval for the Tree Permit. All construction must follow the approved plans for this tree permit without exception. (Planning)
15. All preservation devices (aeration systems, oak tree wells, drains, special paving, etc.) shall be designed and installed as required by these conditions and the arborist's recommendations, and shall be shown on the improvement plans or grading plans. (Planning)
16. If any native ground surface fabric within the Protected Zone must be removed for any reason, it shall be replaced within forty-eight (48) hours. (Planning)
17. Storage or parking of materials, equipment, or vehicles is not permitted within the Protected Zone of any oak tree. Vehicles and other heavy equipment shall not be operated within the Protected Zone of any oak tree. (Planning)
18. Where recommended by the arborist, portions of the foundation shall be hand dug under the direct supervision of the project arborist. The certified arborist shall immediately treat any severed or damaged roots. Minor roots less than one (1) inch in diameter may be cut, but damaged roots shall be traced back and cleanly cut behind any split, cracked or damaged area. Major roots over one (1) inch in diameter may not be cut without approval of an arborist and any arborist recommendations shall be implemented. (Planning)
19. The temporary fencing shall remain in place throughout the entire construction period and shall not be removed without obtaining written authorization from the Planning Division. In no event shall the fencing be removed before the written authorization is received from the Planning Division. (Planning)

PRIOR TO ISSUANCE OF FINAL

20. Within 5 days of the completion of construction, a Certification Letter from a certified arborist shall be submitted to and approved by the Planning Division. The certification letter shall attest to all of the work (regulated activity) that was conducted in the protected zone of the tree, either being in conformance with this permit or of the required mitigation still needing to be performed. (Planning)

Exhibits

- A. Project Plans
- B. *Arborist Report*, Arbor Resources dated July 15, 2023

Note to Applicant and/or Developer: Please contact the Planning Division staff at (916) 774-5276 prior to the Commission meeting if you have any questions on any of the recommended conditions for your project. If you challenge the decision of the Commission in court, you may be limited to raising only those issues which you or someone else raised at the public hearing held for this project, or in written correspondence delivered to the Planning Manager at, or prior to, the public hearing.